

Appendix B: Contextual Design Models

Contents

Workflow Model	34
Cultural Model	35
Sequence Model	36
Artifact Model	37
Physical Models	05
<i>Desk</i>	05
<i>Room</i>	06
<i>Floor Plan</i>	07
Consolidated Artifact Model	08

Cultural Model

Part 1C – Cultural Model

05-610: Homework 2 - Contextual Inquiry & Design
Kodama, Vassallo, Yiu, Zaiss

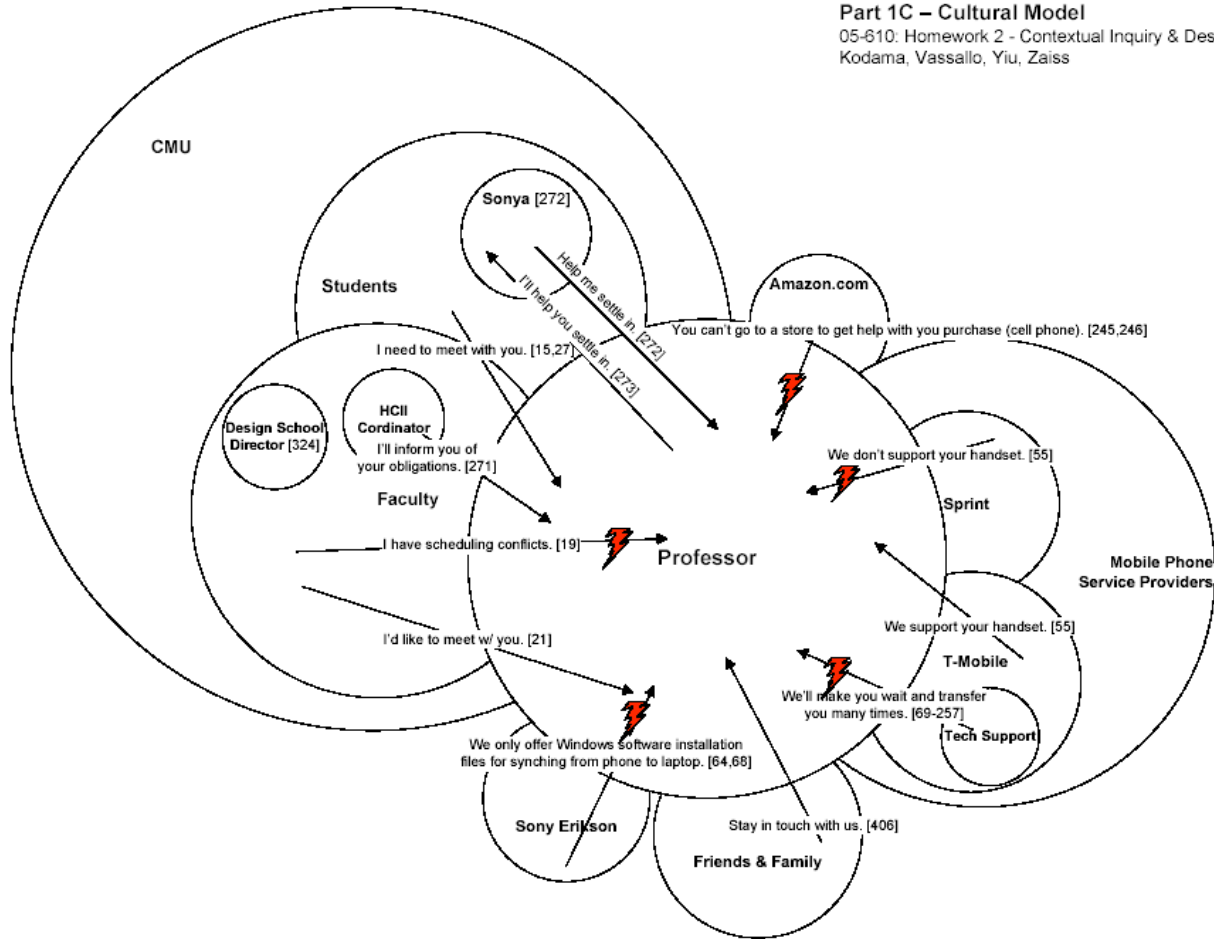

Sequence Model

Sequence Diagram for Getting a New Student Settled In

Intent	Trigger and Sequence	Line #	Breakdown
Greet and welcome student	Trigger: Knock on Door	272	
	Asks about welfare of student	273	
Establish a meeting time, location and activity	Trigger: Wants to setup a meeting	275	
	Suggests meeting time	275	
	Suggested meeting time rejected	276-277	First suggestion rejected
	Asks for student's schedule for rest of week, availability	279-281	
	checks her paper calendar against student free times	283, V4-9:57, 321, artifact	
	Suggest possible activity	285	
	Receives confirmation	286	
	Finalizes time	287	
	Establish meeting place	277	
	Time/ Day is confirmed	288, 289	
Check on welfare of student	Trigger: Wants to ensure student is okay	289	
	Asks when student arrived	289	
	Asks if student is over jetlag and is well rested	291	
	Asks if student needs help with anything	293	
Inform and register student for course	Trigger: Student asks to take a course	298	
	Confirms student request	299	
	Addresses registration concerns	299	
	Informs student of class times	299	
	Confirms time of registration/ first class	300-301	
	Inquiry about room	302	
	Tells student room #	303	Answers wrong question, inefficient
Discuss research lab and meeting time	Trigger: Student inquires about room for research lab	302, 304	
	Tells student room #	305	
	Notifies student of no meeting	305	
	Postpones discussion until Friday	305	
	Confirms that she will inform student of meeting time	305	
Sub-intent: Determine student's schedule	Trigger: Wants to know if a standard meeting is okay	305	
	Asks about other classes	305	
	Confirms day and time of other class	307	
Confirms student has computer	Trigger: Wants to make sure student has computer	309	
	Asks if received a computer	309	
	Confirms	311	
Discuss availability of office/ room space	Trigger: Student asks for room	312	
	Space in design	313	Jodi does not have a room
	Confirms she will talk to Dan	313	
	Reassures her of quality of space	313	
Close and verify meeting time	Trigger: Student begins to leave	314-316	
	Confirms Friday meeting time	317	
Provide herself of reminder of meeting	Trigger: Wants to remember info from meeting	323	
	Puts Friday meeting time into iCal	323	
Help student get an office	Trigger: Follow-up from meeting	324	
	Follow-up item for Dan Boyarski	324	
	Email sent	Video 4-14:19	

Physical Model – Room

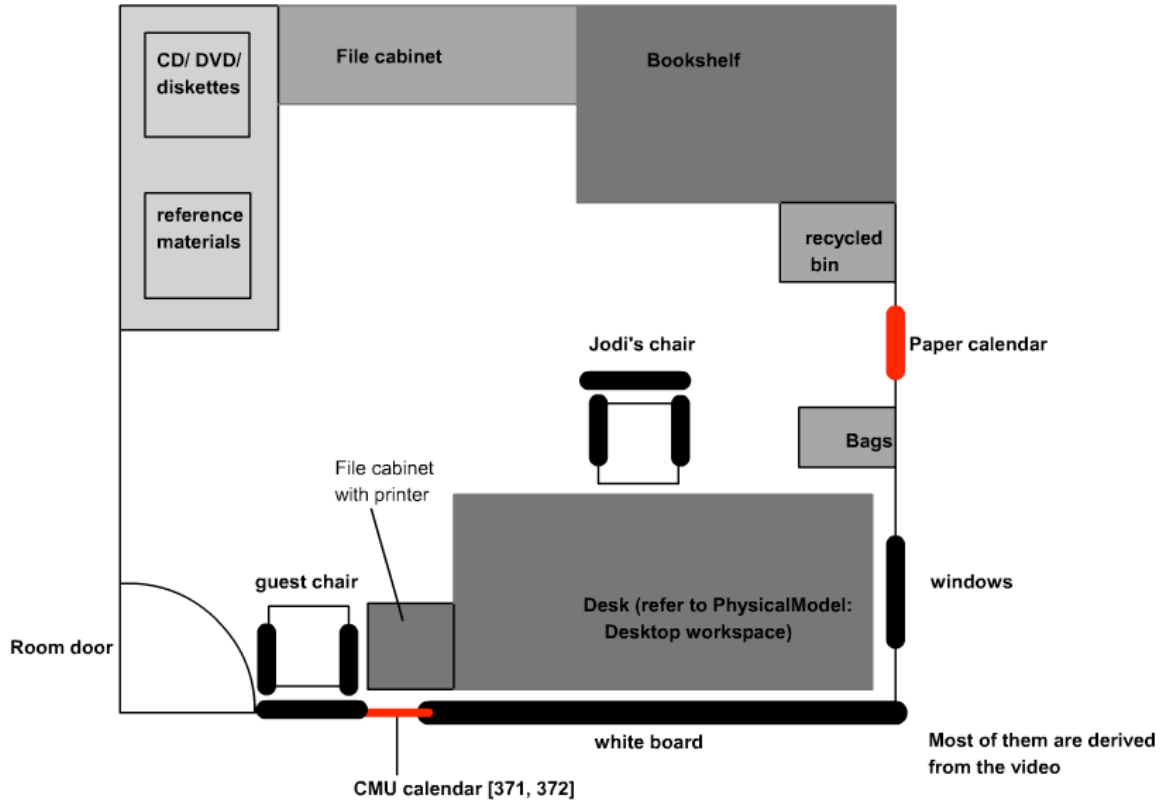

Physical Model (Room Layout)

Group 8: Kodama, Vassallo, Yiu, Zaiss
Part 1E

Physical Model – Floor Plan

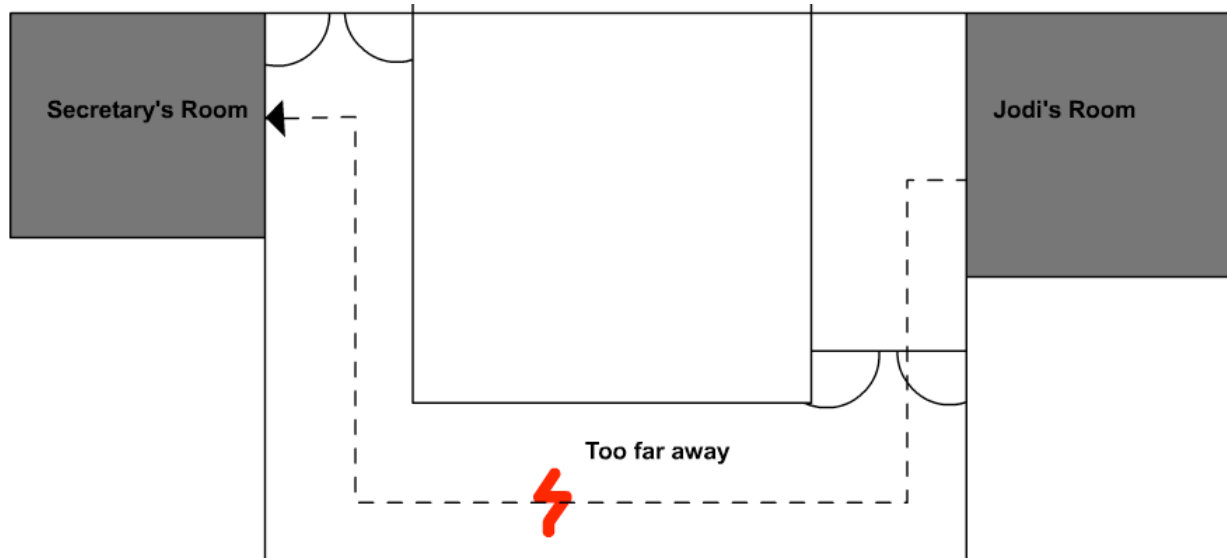

From transcript L91 and video

Physical Model (Floor Plan)

Group 8: Kodama, Vassallo, Yiu, Zaiss
Part 1E

Consolidated Artifact Model

Group 8: Kodama, Vassallo, Yiu, Zaiss

Homework 2: Part 2 - Consolidated Artifact Model

Sun	Mon	Tues	Wed	Thurs	Fri	Sat
			1	2	3	4
5	6	Reminder	8	9	10	11 X:Y0-Y:Y0 Event
12	13 * Imp. Event Highlighted *	14	15	16	17	18
19	20	21 Line used to indicate block of time	22	23 Reminder	24	25
26	27	28	29	30	31	
			Line used to indicate block of time			

Events w/ beginning and end times